

integral LED



INSTALLATION INSTRUCTION for Integral NON MAINTANED Emergency Downlight 3 Year Warranty

Integral Product Code	Description
IEMDL005	Emergency Downlight for Open plan areas
IEMDL014	Emergency Downlight for Corridors / Escape Routes

Important Details – Please read prior to installation

1. This product must be installed by a qualified electrician in accordance with instructions provided and in compliance with recognized electrical and safety regulations relevant to the country it is being installed.
2. Do not lift or carry by the cable or the connector as this may damage the driver/inverter and battery.
3. The product and its associated control gear are designed to operate on 220-240V AC 50Hz.
4. This LED downlight is to be installed in T-bar or void ceilings according to the dimensions below:
LED downlight: 10.5mm, Φ 38mm
Minimum ceiling void height: 150mm
Cut-out: 34mm
Battery: 127mm, Φ 23mm
Inverter: 185x20x20mm
5. This product is for indoor use only and it should not be covered with insulation material.
6. This emergency product contains a HT NI-CD 3.6V 1800mAh battery.
7. A permanent live connection is required for this emergency product to operate normally.
- 8. This product is a Class II device.**

INSTALLATION: DANGER!

Please ensure you isolate live supply before you undertake any work on the emergency fitting.

Installation Instructions

1. Ensure the AC/mains power is not connected and cannot be reconnected during installation.
2. Clear a position for the LED downlight to be placed in ceiling.
3. Remove the downlight from the packaging box.
4. Follow diagram in Figure 1 and cable legend below:
 - Brown: permanent LIVE
 - Blue: neutral
5. Mark the installation date on the battery pack label.
6. Ensure battery is connected.
7. Place the LED downlight into the ceiling space following steps in Figure 2.
8. When ready switch on the mains power supply.
9. A green LED indicator light will be present to show that the batteries are charging. Full charge can take up to 24 hours. On first installation, ensure fittings have received a full 24 hours charge before testing.
10. If green LED indicator light is not present check connections and check faults.

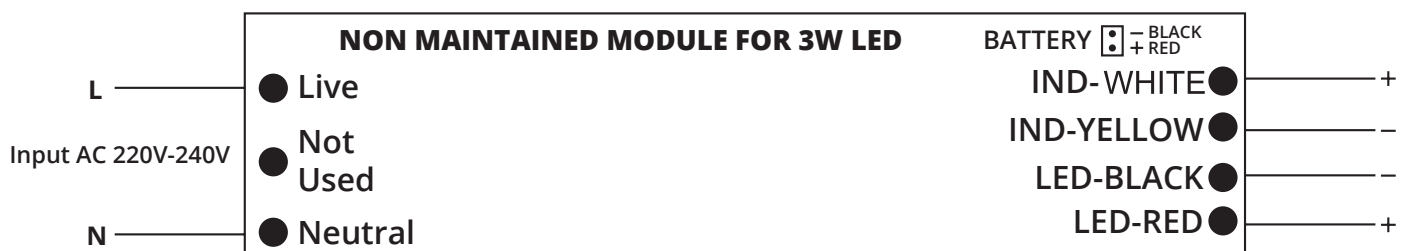

Figure 1

When powered by a permanent mains supply, the battery will be constantly charged whether or not lamp the lamp is illuminated.

On failure of the permanent mains supply, the green LED indicator will extinguish and the fitting will switch automatically from battery charging to battery discharge powering the LED downlight. This product is designed to provide 3hrs of light following a power failure. The power consumed by this product in standby mode is less than 1W when the product is fully charged. For replacement unit please contact Integral-LED.com

Installation Diagram

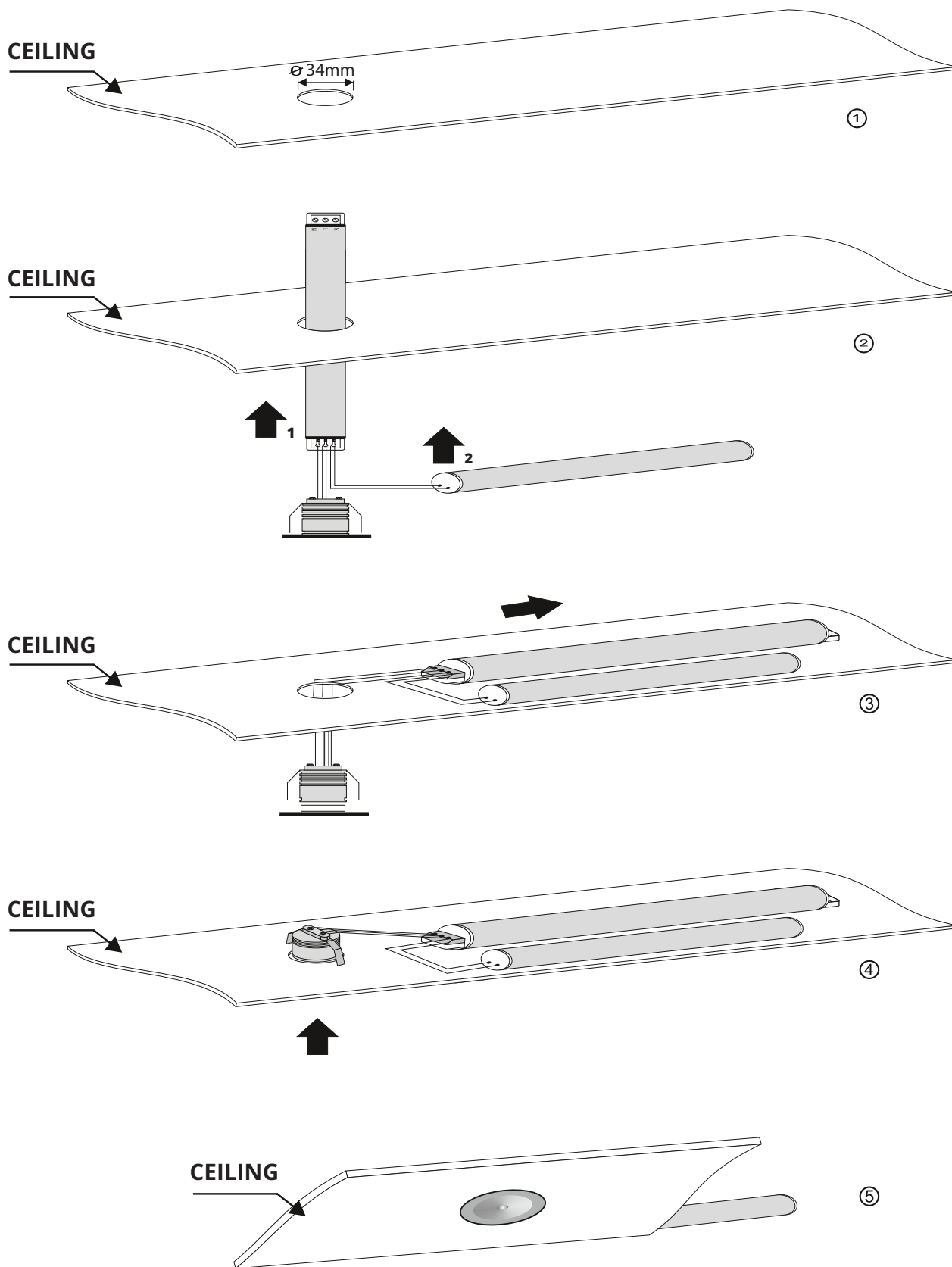

Figure 2



This luminaire is designed according to BS EN 60598-2-22

Warranty/technical and contact information are all available at www.integral-led.com

Test Schedule to record monthly functional test and yearly 3 hour duration test.

All testing should be planned and incorporated as part of a managed programme with appropriate risk assessment to ensure operational emergency function is not compromised during testing.

Panel Ref/Location 	In case of difficulty, contact the Installation Engineers: tel.					
Full Recharge Time 24 Hours			Duration 3 Hours			
TEST RECORD						
	Year 1		Year 2		Year 3	
Monthly Test	Signed	Date	Signed	Date	Signed	Date
Functional						
Functional						
Functional						
Functional						
Functional						
Functional						
Functional						
Functional						
Functional						
Functional						
Functional						
Three Hour						

